



# The Old Brewery

KING STREET, SCARBOROUGH

Ten traditionally styled  
1 & 2 Bedroom Apartments

[www.thompsonhomes.co.uk](http://www.thompsonhomes.co.uk)

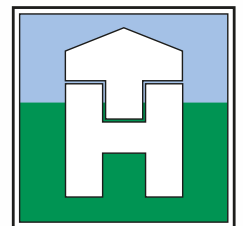

**THOMPSON  
HOMES**  
(YORKSHIRE) LIMITED



Registered developer

# The Old Brewery

King Street, Scarborough

- A new development of ten traditionally styled 1 and 2 bedroom apartments, built in 2 blocks.
- Some have breathtaking sea views across the South Bay\*.
- Central location in easy reach of town centre and seaside amenities.
- Ideal starter home or holiday home.
- Limited allocated off-street parking



This is the full panoramic view across the South Bay from plot 9.

## 1 & 2 Bedroom Apartments Specification

### Hallway

- Pendant light fitting
- Electric point
- Smoke detector

### Kitchen

- Modern quality fitted kitchen with laminate worktops and stainless steel sink includes conventional electric cooker, gas hob, chimney extract and integrated fridge/freezer. Kitchen to include under-counter space and plumbing for washing machine.
- Halogen or similar lighting
- Multiple electric points
- Heat detector

### Living Room

- Pendant light fitting
- Numerous electric points
- TV point
- Telephone point

### Bedroom 1

- Pendant light fitting
- Numerous electric points
- TV point
- Telephone point

### Bedroom 2 (where applicable)

- Pendant light fitting
- Numerous electric points
- TV point

### Bathroom

- Modern white bathroom suite with over-bath shower
- Part tiled walls with splash-back
- Halogen or similar lighting

### General

- Gas combi-boiler central heating with a conventional radiator system
- All windows to be uPVC double glazed units
- Limited parking spaces available – see Agent

# GROUND FLOOR PLAN

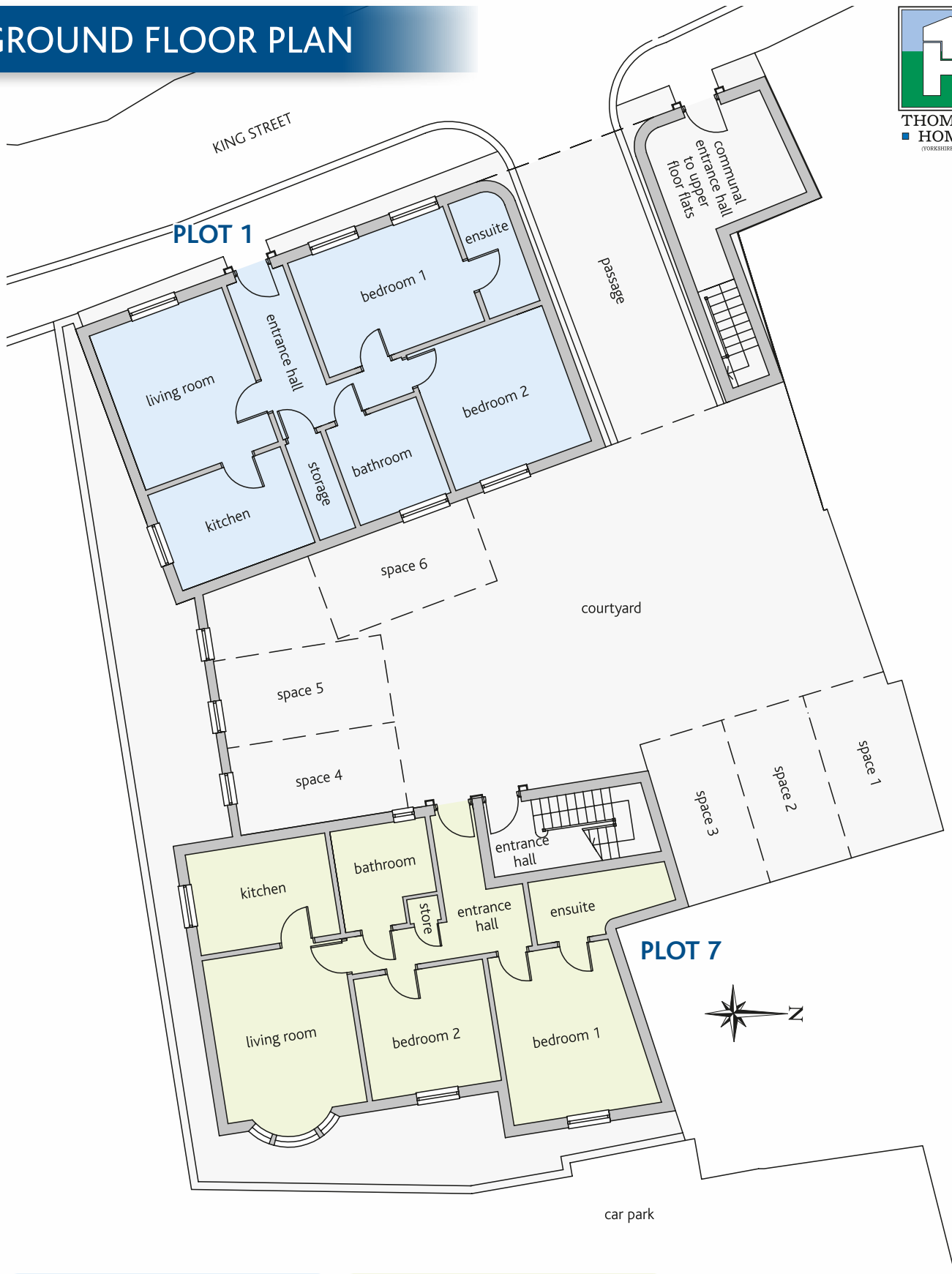

PLOT 1*	METRIC	IMPERIAL
Living Room	4.6 x 4.0	15'1" x 13'1"
Kitchen	2.8 x 4.0	9'2" x 13'1"
Storage	1.0 x 2.8	3'3" x 9'2"
Bathroom	2.8 x 2.8	9'2" x 9'2"
Bedroom 1	4.6 x 3.4	15'1" x 11'1"
Ensuite	1.5 x 3.4	4'11" x 11'1"
Bedroom 2	4.0 x 4.0	13'1" x 13'1"

PLOT 7**	METRIC	IMPERIAL
Living Room	4.0 x 5.2	13'1" x 17'
Kitchen	4.0 x 2.8	13'1" x 9'2"
Store	0.9 x 0.8	2'11" x 2'7"
Bathroom	2.7 x 2.8	8'10" x 9'2"
Bedroom 1	4.2 x 4.5	13'9" x 14'9"
Ensuite	2.7 x 1.8	8'10" x 5'10"
Bedroom 2	3.7 x 3.5	12'1" x 11'5"

\* Please note that this apartment has its own entrance on King Street.

\*\* Please note that this apartment has its own entrance in the courtyard.

(To be used as a guide only. Max. room dimensions are always given)

[www.thompsonhomes.co.uk](http://www.thompsonhomes.co.uk)

# FIRST FLOOR PLAN



## PLOT 2

	METRIC	IMPERIAL
Living Room	3.2 × 5.5	10'5" × 18'
Kitchen Area	3.2 × 2.8	10'5" × 9'2"
Bedroom 1	3.7 × 3.5	12'1" × 11'5"
Bathroom	1.9 × 2.5	6'2" × 8'2"
Hall	1.8 × 2.7	5'10" × 8'10"

## PLOT 3

	METRIC	IMPERIAL
Living Room	4.0 × 4.6	13'1" × 15'1"
Kitchen	2.8 × 4.0	9'2" × 13'1"
Bathroom	2.6 × 1.8	8'6" × 5'10"
Bedroom 1	4.3 × 3.4	14'1" × 11'1"
Bedroom 2	3.8 × 2.9	12'5" × 9'6"

## PLOT 8

	METRIC	IMPERIAL
Living Room	4.0 × 5.2	13'1" × 17'
Kitchen	4.0 × 2.8	13'1" × 9'2"
Store	0.9 × 0.8	2'11" × 2'7"
Bathroom	2.7 × 2.8	8'10" × 9'2"
Bedroom 1	4.2 × 4.5	13'9" × 14'9"
Ensuite	2.7 × 1.8	8'10" × 5'10"
Bedroom 2	3.7 × 3.5	12'1" × 11'5"

(To be used as a guide only. Max. room dimensions are always given)

# SECOND FLOOR PLAN

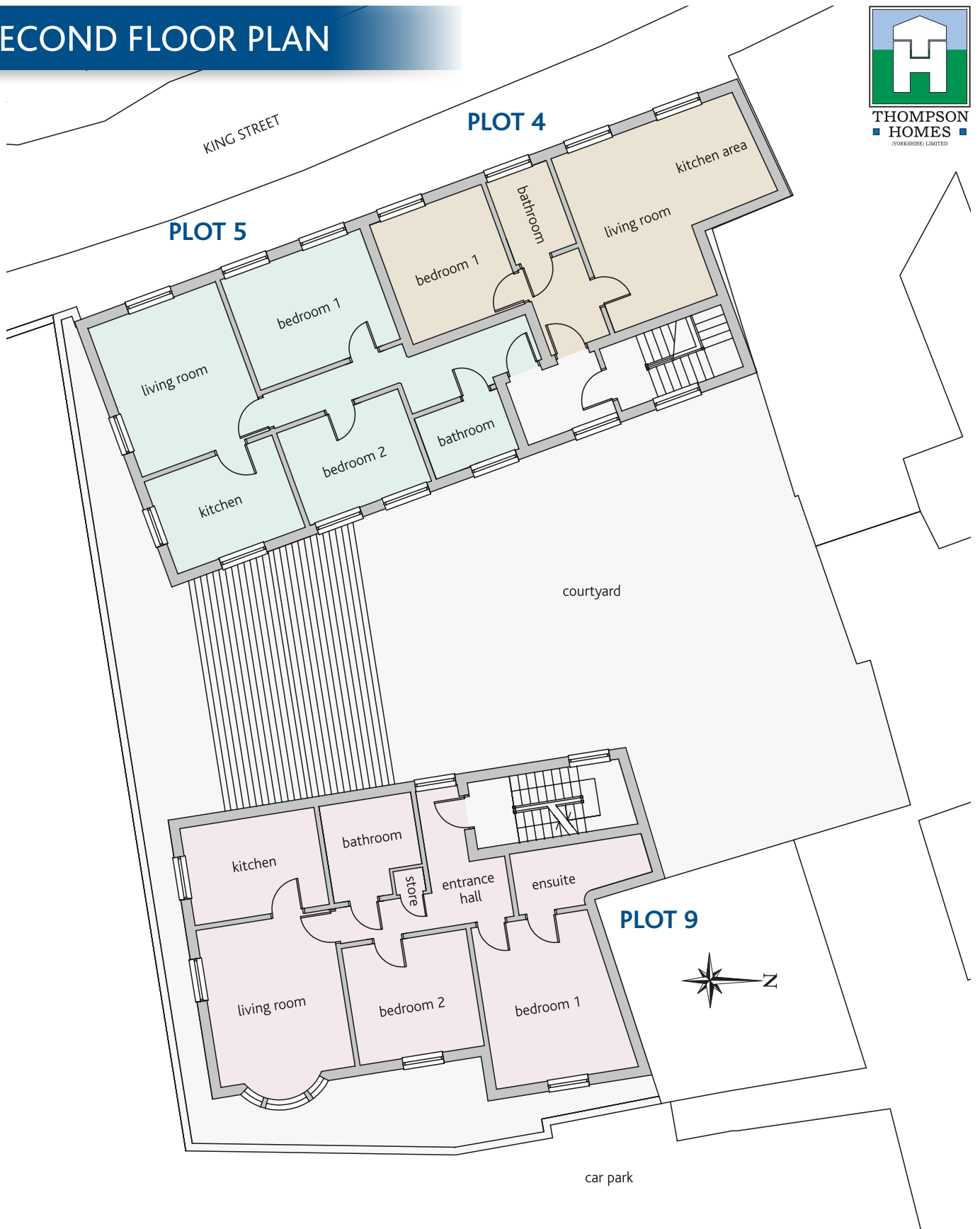

## PLOT 4

	METRIC	IMPERIAL
Living Room	3.2 x 5.5	10'5" x 18'
Kitchen Area	3.2 x 2.8	10'5" x 9'2"
Bedroom 1	3.7 x 3.5	12'1" x 11'5"
Bathroom	1.9 x 2.5	6'2" x 8'2"
Hall	1.8 x 2.7	5'10" x 8'10"

## PLOT 5

	METRIC	IMPERIAL
Living Room	4.0 x 4.6	13'1" x 15'1"
Kitchen	2.8 x 4.0	9'2" x 13'1"
Bathroom	2.6 x 1.8	8'6" x 5'10"
Bedroom 1	4.3 x 3.4	14'1" x 11'1"
Bedroom 2	3.8 x 2.9	12'5" x 9'6"

## PLOT 9

	METRIC	IMPERIAL
Living Room	4.0 x 5.2	13'1" x 17'
Kitchen	4.0 x 2.8	13'1" x 9'2"
Store	0.9 x 0.8	2'11" x 2'7"
Bathroom	2.7 x 2.8	8'10" x 9'2"
Bedroom 1	4.2 x 4.5	13'9" x 14'9"
Ensuite	2.7 x 1.8	8'10" x 5'10"
Bedroom 2	3.7 x 3.5	12'1" x 11'5"

(To be used as a guide only. Max. room dimensions are always given)

# THIRD FLOOR PLAN

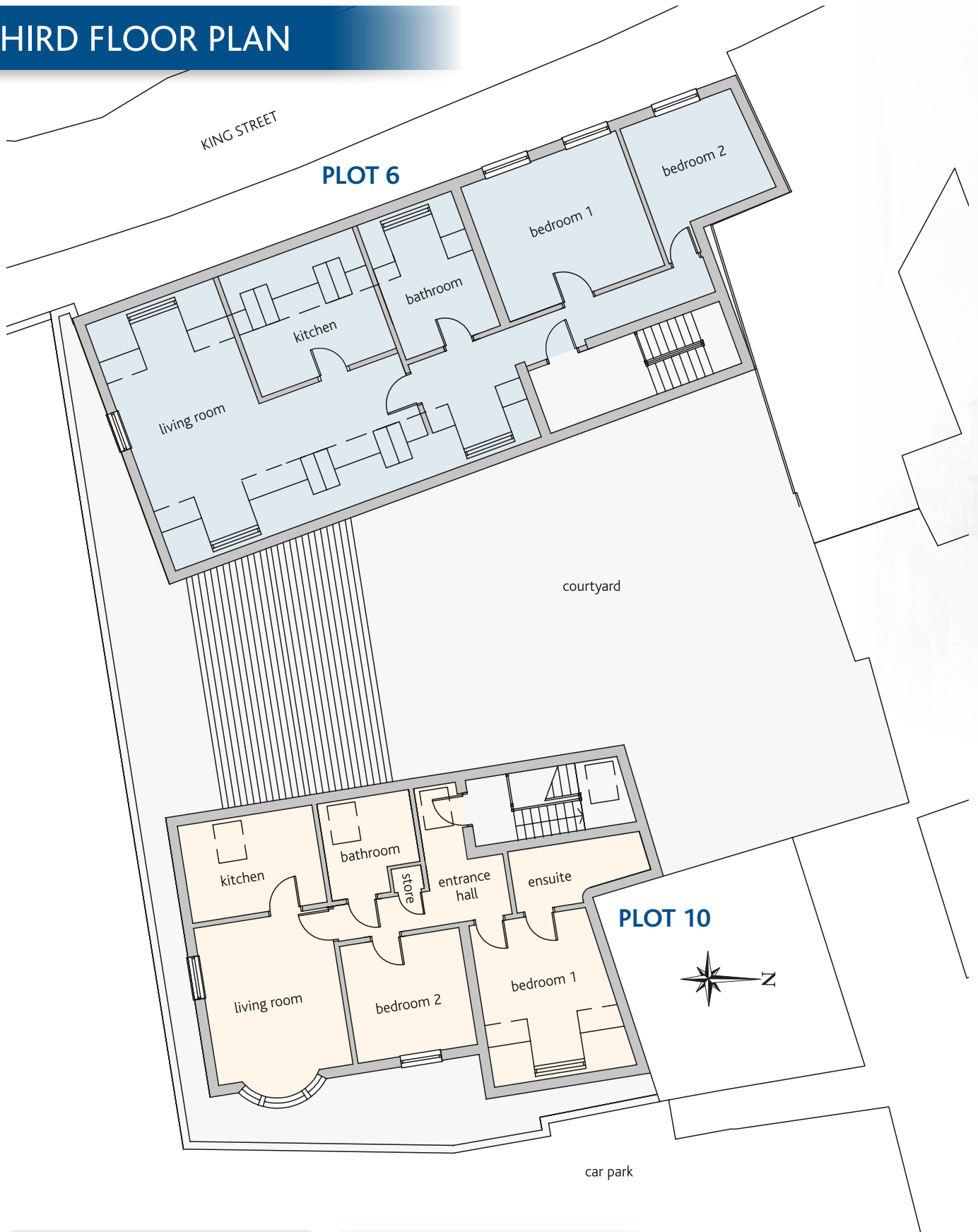

## PLOT 6

	METRIC	IMPERIAL
Living Room	6.7 × 4.0	21'11" × 13'1"
Kitchen	4.2 × 3.5	13'9" × 11'5"
Bathroom	2.8 × 3.8	9'2" × 12'5"
Bedroom 1	4.8 × 4.2	15'8" × 13'9"
Bedroom 2	3.5 × 4.2	11'5" × 13'9"

## PLOT 10

	METRIC	IMPERIAL
Living Room	4.0 × 5.2	13'1" × 17'
Kitchen	4.0 × 2.8	13'1" × 9'2"
Store	0.9 × 0.8	2'11" × 2'7"
Bathroom	2.7 × 2.8	8'10" × 9'2"
Bedroom 1	4.2 × 4.5	13'9" × 14'9"
Ensuite	2.7 × 1.8	8'10" × 5'10"
Bedroom 2	3.7 × 3.5	12'1" × 11'5"

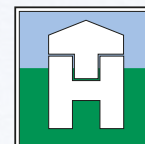

THOMPSON  
HOMES  
(YORKSHIRE) LIMITED





### Shepherd's Croft

HIGH STREET, SNAINTON

2 x 4 Bedroom Houses

[www.thompsonhomes.co.uk](http://www.thompsonhomes.co.uk)





### West Parade Court

WEST PARADE ROAD, SCARBOROUGH

6 x 3 Bedroom Houses  
1 x 2 Bedroom Houses

[www.thompsonhomes.co.uk](http://www.thompsonhomes.co.uk)





### Constable Court

MURRAY STREET, FILEY

5 x 3 Bedroom Houses with parking

[www.thompsonhomes.co.uk](http://www.thompsonhomes.co.uk)





### The Old Police Station

MURRAY STREET, FILEY

4 Modern Spacious Apartments

[www.thompsonhomes.co.uk](http://www.thompsonhomes.co.uk)





### Norwood Court

NORWOOD STREET, SCARBOROUGH

6 x 2 Bedroom Houses  
1 x 3 Bedroom House  
1 x 3 Bedroom Detached House

[www.thompsonhomes.co.uk](http://www.thompsonhomes.co.uk)





### Jubilee Court

STATION AVENUE, FILEY

2 x 4 Bedroom Houses  
12 x 2 Bedroom Apartments

[www.thompsonhomes.co.uk](http://www.thompsonhomes.co.uk)



# Renowned for building Quality Homes on the Yorkshire Coast



## ALSO DEVELOPING SITES AT

West Parade Road,  
Scarborough

Racecourse Road,  
East Ayton

Murray Street, Filey  
Southdene, Filey

Harvest Way, Scarborough  
Holbeck Hill, Scarborough

High Street, Snainton

Bowling Green Lane,  
Hunmanby

*Please telephone our office to be added to our priority mailing list. 01723 870345*

## Thompson Property

Residential • Commercial • Industrial

[www.thompsonproperty.co.uk](http://www.thompsonproperty.co.uk)

Our extensive property rental portfolio is based generally in the Scarborough area and within a 10 mile radius of the town centre. The majority of our rental stock has been built within the last 10 years by Thompson Homes and boasts good levels of energy efficiency as well as being well maintained to modern standards. We have Domestic Residences, Industrial and Commercial Lettings.

For up-to-date information visit our website [www.thompsonproperty.co.uk](http://www.thompsonproperty.co.uk)

Or alternatively email us on [info@thompsonproperty.co.uk](mailto:info@thompsonproperty.co.uk) or telephone (01723) 870345



Beacon Works, Barmoor Lane, Scalby, Scarborough  
North Yorkshire YO13 0PQ

Tel: 01723 870345  
[enquiries@thompsonhomes.co.uk](mailto:enquiries@thompsonhomes.co.uk)

[www.thompsonhomes.co.uk](http://www.thompsonhomes.co.uk)



Registered developer